

# CRH1820BL

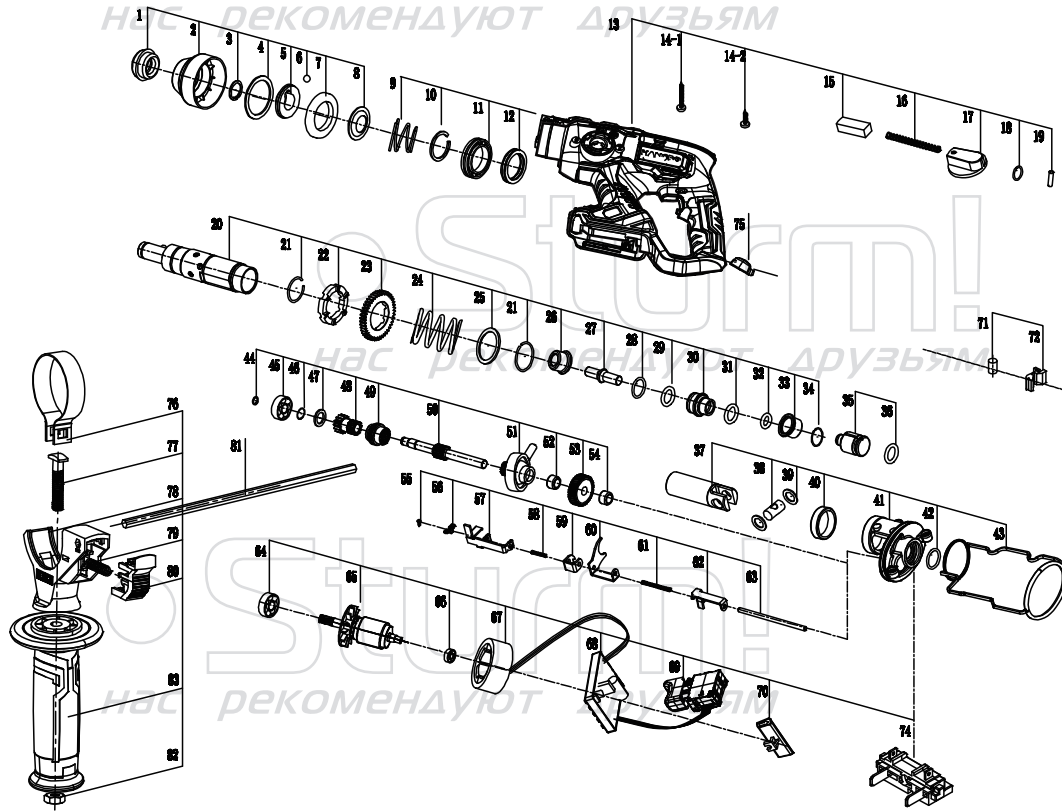

NO.	DESCRIPTION	SPEC.	NO.	DESCRIPTION	SPEC.
1	DUSTPROOF CAP		42	O – RING	
2	PROTECTION SLEEVE		43	SEALING RING	
3	CIRCLIP	Φ 14.8	44	CIRCLIP	Φ 7
4	WASHER	Φ 24.8 × Φ 30.6 × 1	45	BEARING	627RS
5	PROTECTION SLEEVE WASHER		46	CIRCLIP	Φ 8
6	STEEL BALL	Φ 7.1	47	MIDDLE GEAR WASHER	
7	WASHER		48	MIDDLE GEAR	
8	SPRING SEAT		49	CLUTCH DISK 2	
9	SPRING		50	MIDDLE SHAFT	
10	CIRCLIP	Φ 25	51	ROCKER BEARING	
11	BEARING	6805RS	52	NEEDLE BEARING	HK081117
12	OIL SEAL		53	BEVEL GEAR	
13	HOUSING		54	NEEDLE BEARING	HK0808
14 – 1	SCREW	ST4X24	55	SCREW	ST3X14
14 – 2	SCREW	ST4X16	56	PRESS PLATE	
15	LOCKING BUTTON		57	SHIFTING GEAR UNIT 1	
16	SPRING		58	SPRING	
17	SELECTOR KNOB		59	SHIFTING GEAR UNIT 2	
18	O – RING		60	SHIFTING GEAR UNIT 3	
19	PIN OF KNOB		61	SPRING	
20	ROTARY SLEEVE		62	SHIFTING GEAR UNIT 4	
21	CIRCLIP	Φ 1.6X28	63	FUNCTION SWITCHING SHAFT	
22	CLUTCH DISK 1		64	BEARING	608RZ
23	BIG GEAR		65	ROTOR	
24	SPRING		66	BEARING	626Z
25	WASHER	Φ 10.3 × Φ 49 × 1	67	STATOR	
26	HAMMER ROD FIXED SLEEVE		68	MOTOR PCB	
27	HAMMER ROD		69	SWITCH	
28	O – RING		70	PUSH ROD	
29	O – RING		71	SHOCK ABSORBER PAD	
30	GUIDE BUSHING		72	FIXED BLOCK	
31	O – RING		74	BATTERY PACK CONNECTOR	
32	O – RING		75	LAMP COVER	
33	FIXED SLEEVE		76	CLAMPING BAND	
34	CIRCLIP	Φ 1.6X24.2	77	T- BOLT	
35	PISTON		78	CLAMP HOLDER	
36	O – RING		79	SPRING	
37	CYLINDER		80	DEPTH RULER LOCK	
38	CYLINDER PIN		81	DEPTH RULER	
39	CYLINDER PIN WASHER		82	NUT	M8
40	BUSHING		83	AUXILIARY HANDLE	
41	BRACKET				